

STRAIGHTLINE

PROFESSIONAL DRILLING SOLUTIONS

BREAKOUT WRENCH KIT 80789

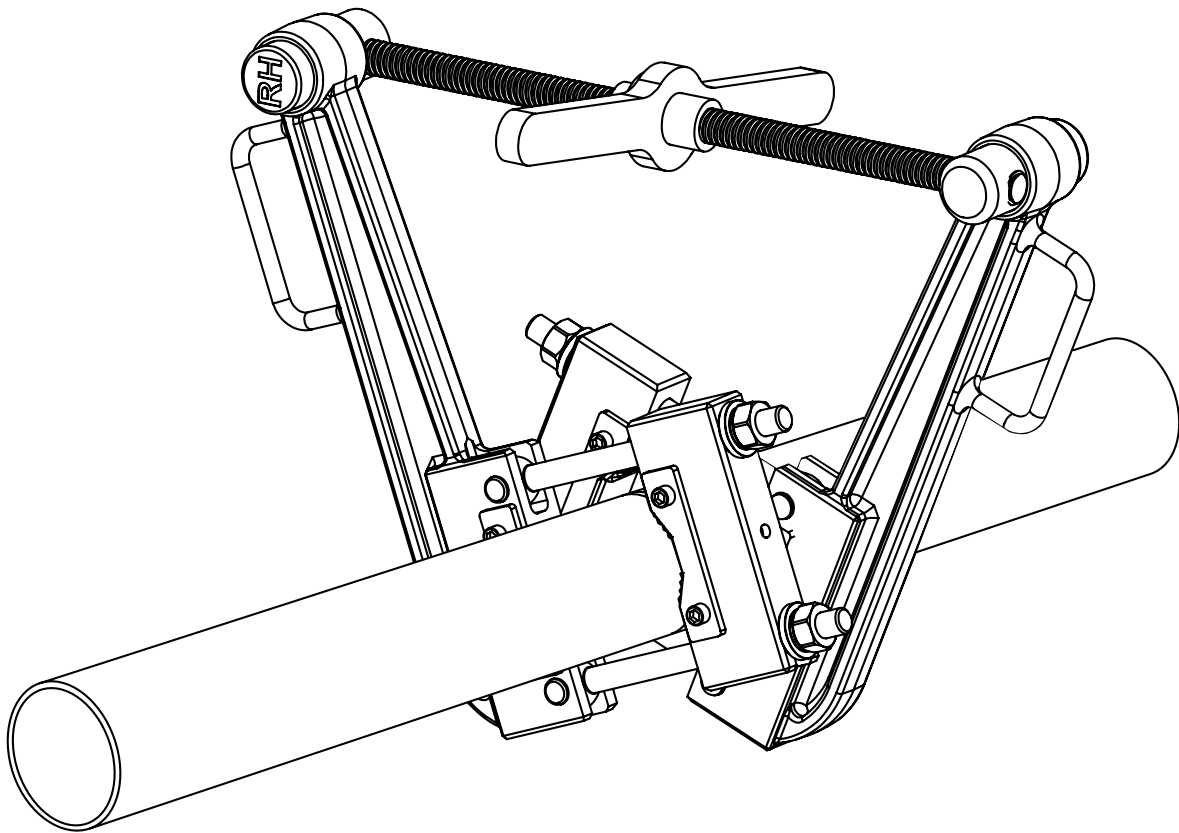

VERSION 1, JULY 2014

BREAKOUT WRENCH

Proper use of the StraightLine Breakout Wrench Kit

In order to properly “make up” or “break out” the tool joints when attaching air hammer threaded components to each other, or the drill string, always use the available Straight-Line breakout wrench kit, or an equivalent. See **FIG. 1**.



WARNING Rotating Parts

Never use rig power or other powered equipment when making up or breaking out threaded connections. Serious injury or death may result from rotating parts or from thrown wrenches.

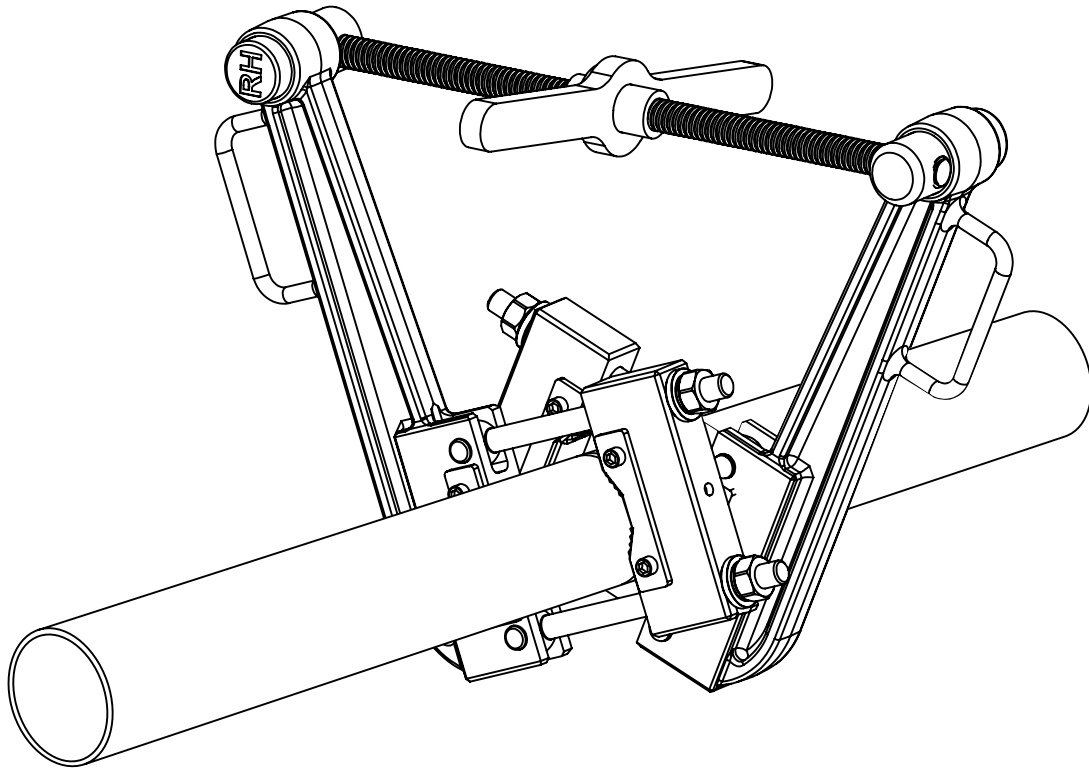

FIG 1

1. To make up a joint, thread the two components together by hand until the joint is hand tight. See **FIG 2**.

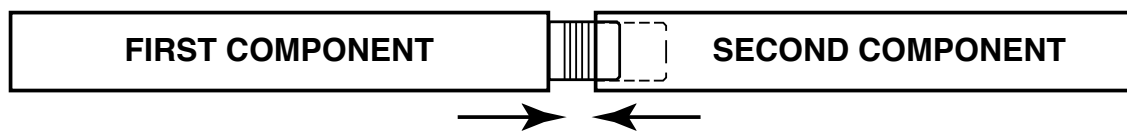

FIG 2

2. Attach wrench handle to first component. Tighten nuts to secure removable die holder. See **FIG 3**.

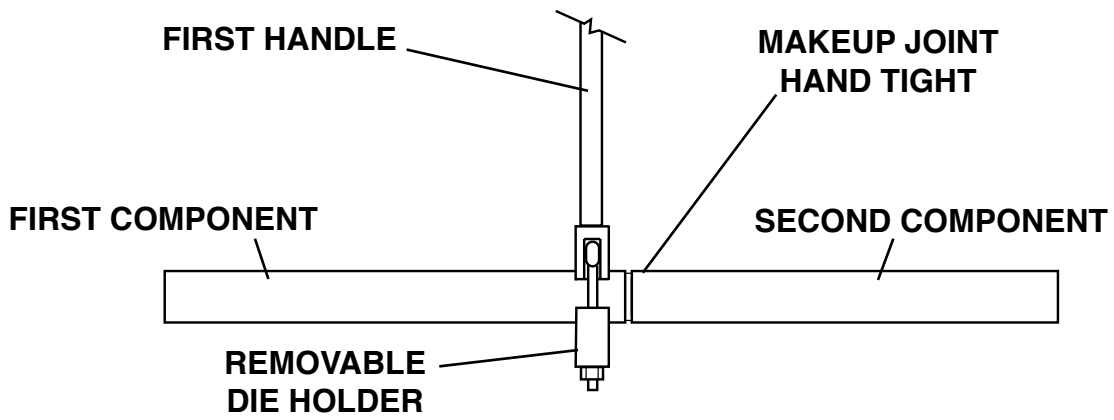

FIG 3

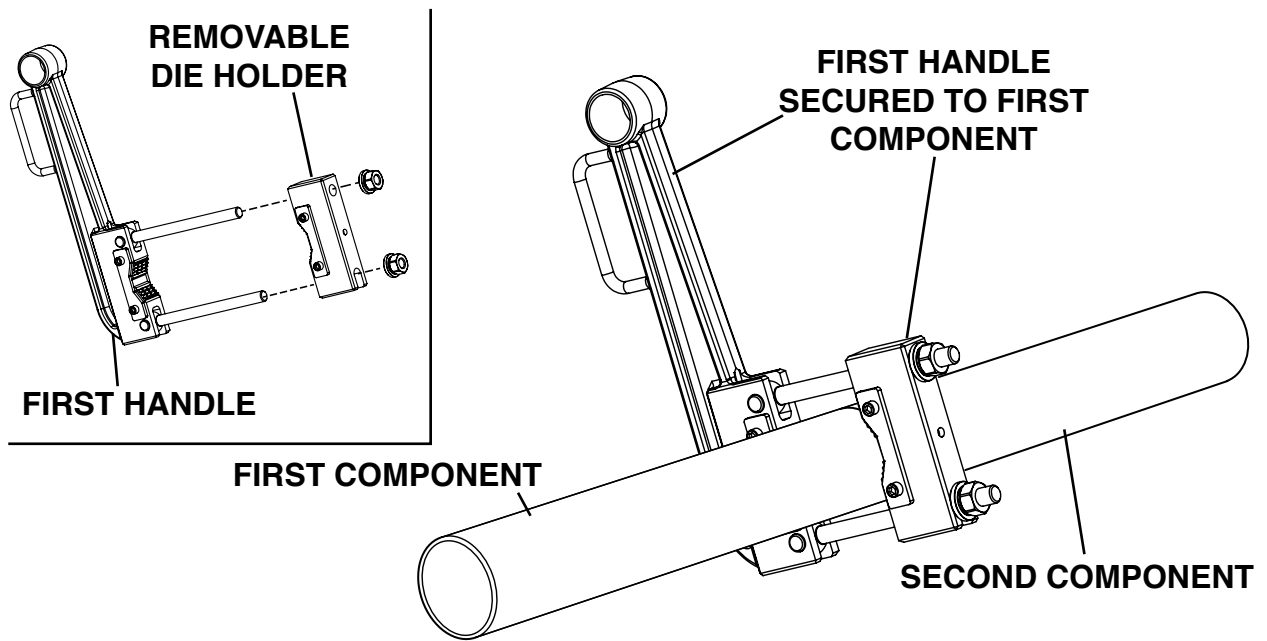

FIG 4

3. Assemble the remaining StraightLine Breakout Wrench parts, including second handle and spinner handle as illustrated. See FIG 5, 6, 7.

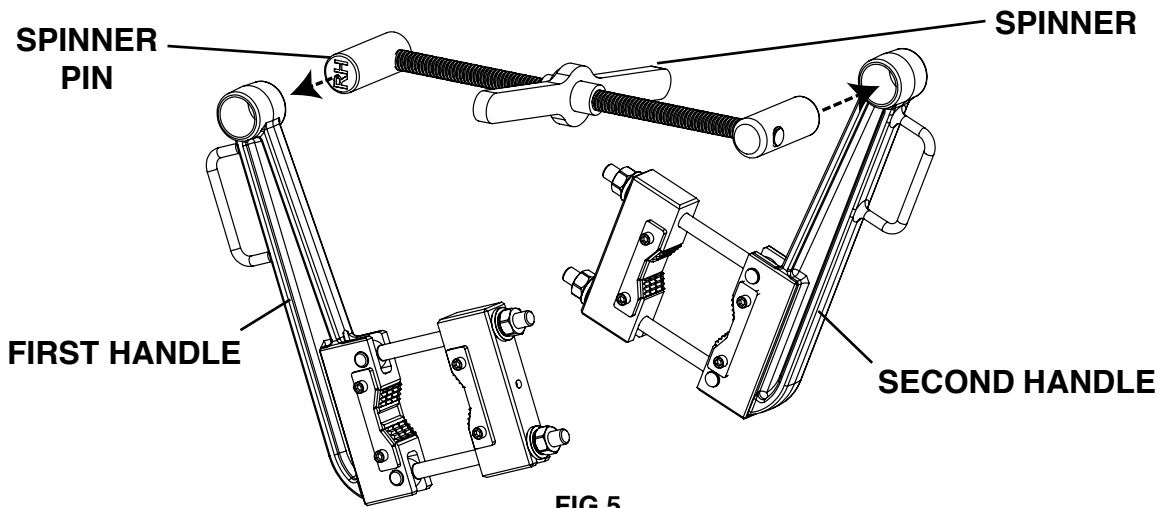

FIG 5

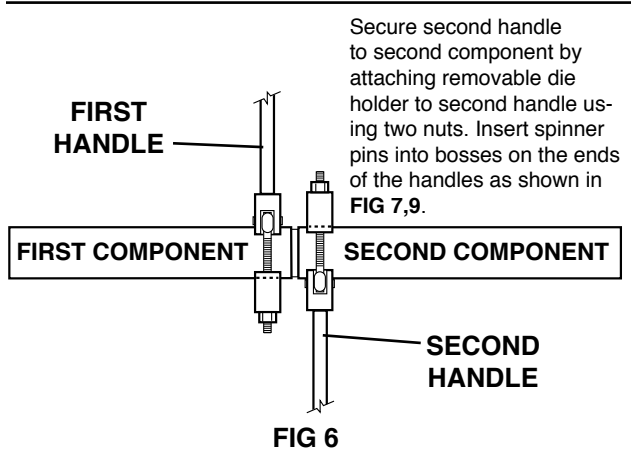

FIG 6

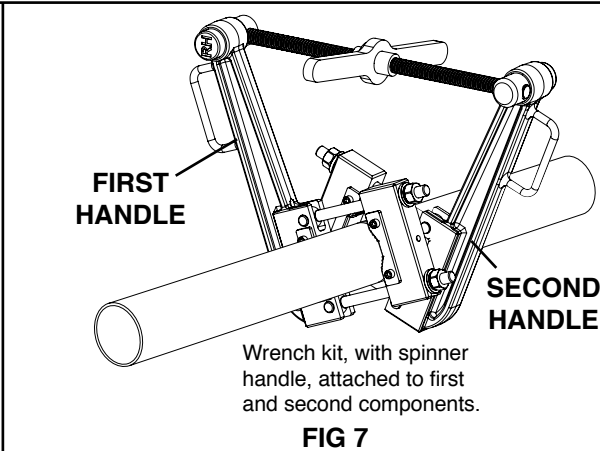

FIG 7

4. Turn the spinner handle in a direction that draws the first and second wrench handles toward each other, thereby tightening the joint between first and second components. Continue tightening until the two components make full shoulder contact, then continue to turn spinner handle for 1/4 to 1/2 revolution. The joint is now properly tightened. See FIG 8, 9.

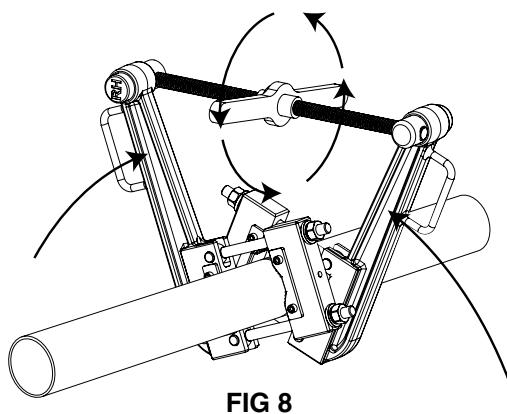

FIG 8

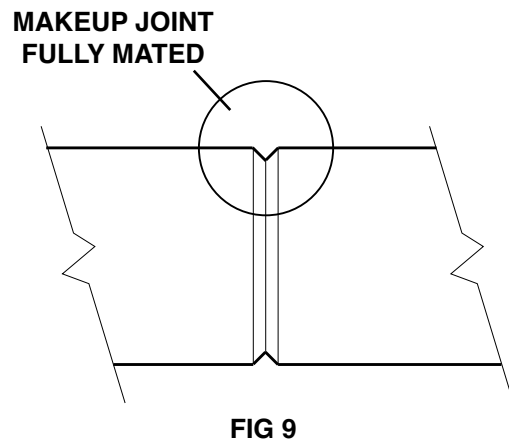

FIG 9

5. In order to “Break” a joint free, follow the preceding steps in the same order, but flip the position of the handles so that the two components unthread. See **FIG 10**. The first handle attaches to the second component and the second handle attaches to the first component. Flip the spinner pins 180 degrees. See **FIG 5** for reference.

NOTE: Always have the breakout wrench pull together. Never have it push components apart.

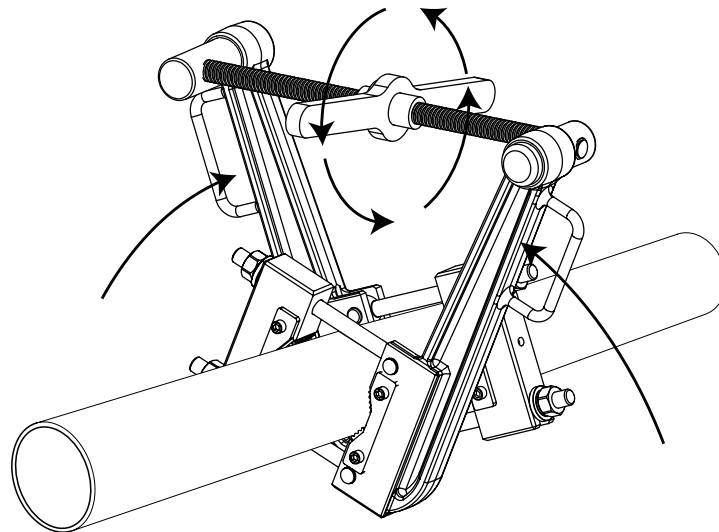

FIG 10